



Medallion

DIVISION OF STURLA INC.

2434 Polvorosa Ave, San Leandro CA 94577, 510 351-8104, Fax 510 483-4874

839 F Street Suite 100, West Sacramento CA 95605, 916 372-8501, Fax 916 372-2175

645 Ahua Street, Honolulu HI 96819, 808 836-3585, Fax 808 834-4722

www.Medallion1.com

Portuguese 6mm (1/4") Cork Underlayment

Item# 610943



Sizes: 24" x 36" Sheets

Versatile: Use with Wood or Ceramics

Origin: Portuguese Cork (Not Chinese)

Real World Sound Tests: No Ceiling Assemblies

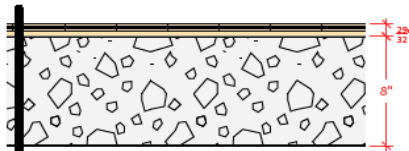

Engineered Wood/bois d'ingénierie 12,7 mm
 Po...od Flooring Adhesive
 [Urriac 9200]
 Flat Cork/liège plat 6.0 mm
 Po...od Flooring Adhesive
 [Urriac 9200]
 Concrete Slab/dalle de béton 8" [200 mm]
 Glaze/enduit lisse

417 TO/VERS 317

FIIC ASTM	dB(A)	$\Sigma\Delta$	n Δ	Δ_{max}
61	62,9	31,4	10	5,9

417 TO/VERS 317 (CONCRETE/BÉTON)

FIIC ASTM	dB(A)	$\Sigma\Delta$	n Δ	Δ_{max}
34	79,4	11,8	2	8,0

MEASUREMENT CONDITIONS/CONDITIONS DE MESURES [317]:
 Closed Space/local fermé
 Painted Walls/murs peints
 Concrete Floor/plancher au béton
 Volume = 1087 cu.ft. [30,77 m³]

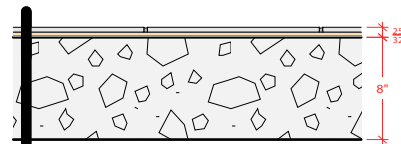

Ceramic Tile/céramique 3/8"
 Latex Modified Thin-set
 [Proma P-151]
 Flat Cork/liège plat 6.0 mm
 Latex Tile Mastic

Concrete Slab/dalle de béton 8" [200 mm]
 Glaze/enduit lisse

417 TO/VERS 317

FIIC ASTM	dB(A)	$\Sigma\Delta$	n Δ	Δ_{max}
56	67,4	31,6	10	7,8

417 TO/VERS 317 (CONCRETE/BÉTON)

FIIC ASTM	dB(A)	$\Sigma\Delta$	n Δ	Δ_{max}
34	79,4	11,8	2	8,0

MEASUREMENT CONDITIONS/CONDITIONS DE MESURES [317]:
 Closed Space/local fermé
 Painted Walls/murs peints
 Concrete Floor/plancher au béton
 Volume = 1087 cu.ft. [30,77 m³]